

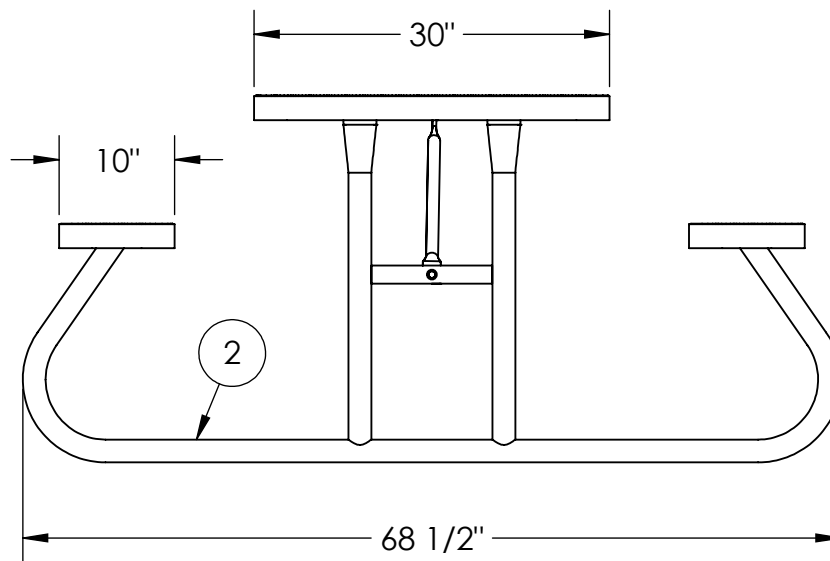

6' Champion Expanded Metal Free Standing Picnic Table

924-301

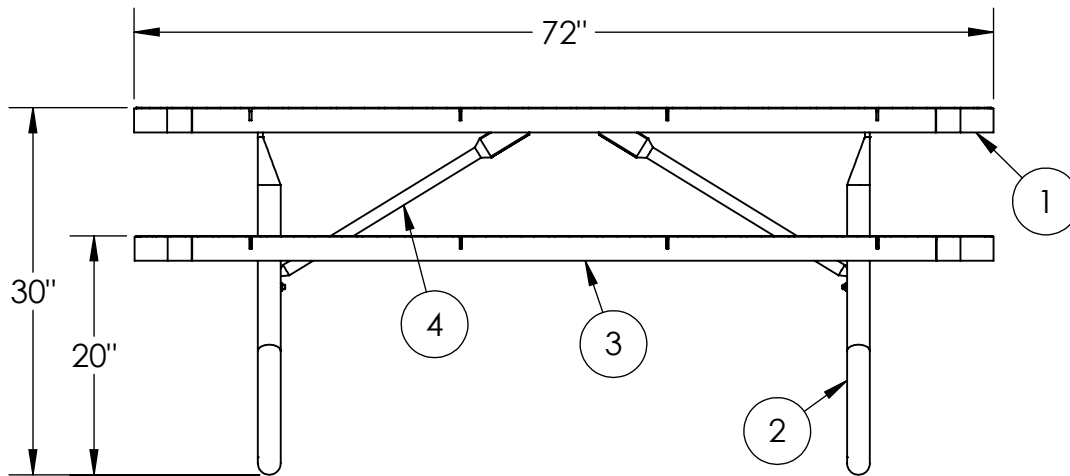

ITEM NO.	PART NUMBER	DESCRIPTION	QTY.
1	642-013	6' Champion Table Top (QS)	1
2	634-010	Free Standing Table Stand For 10" Seats	2
3	622-013	6' Champion Seat/Back (QS)	2
4	634-013A	Table Brace	2
5	516-058	3/8"x1-1/2" SS Hex Bolt	16
6	516-023	3/8" SS Flat Washer	32
7	516-028	3/8" SS Nylock Nut	16



PREMIER POLYSTEEL

The Best Commercial Outdoor Furniture Available. Period.



SIZE
A

REV. X.01 SHEET 1 OF 2

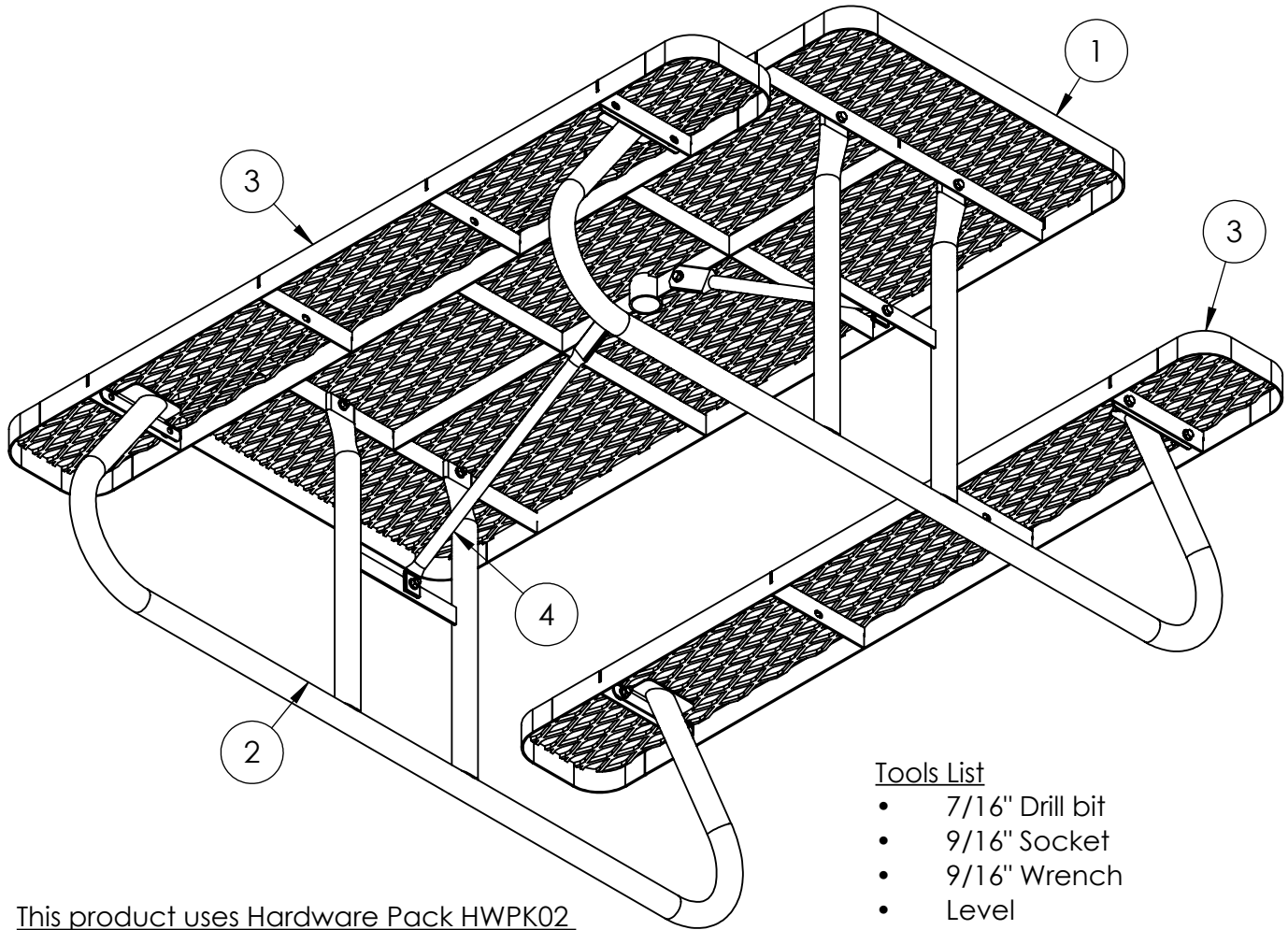

This product uses Hardware Pack HWPK02
(you may receive extra hardware)

- 16 qty. 3/8" x 1-1/2" SS Hex Bolt
- 16 qty. 3/8" SS Nylock Nut
- 32 qty. 3/8" SS Flat Washer

Tools List

- 7/16" Drill bit
- 9/16" Socket
- 9/16" Wrench
- Level
- Impact Gun (Optional)
- Drill

1. Drill out all holes using a 7/16" diameter drill bit.
2. Place the tabletop upside down on top of a pair of sawhorses or 12" blocks (cover the blocks with cardboard).
3. Attach both stands to the inside of table support bar. (See diagram above). Do not tighten completely.
4. Attach the straight end of each brace to the table. (See diagram above)
5. Attach bent end of both braces to the cross bar of each stand. (See diagram above)
6. Turn the table over.
7. Attach the seats to the stands.
8. Level the seats and table then tighten up bolts.

Periodic check of bolts tightness recommended



PREMIER POLYSTEEL

The Best Commercial Outdoor Furniture Available. Period.

