

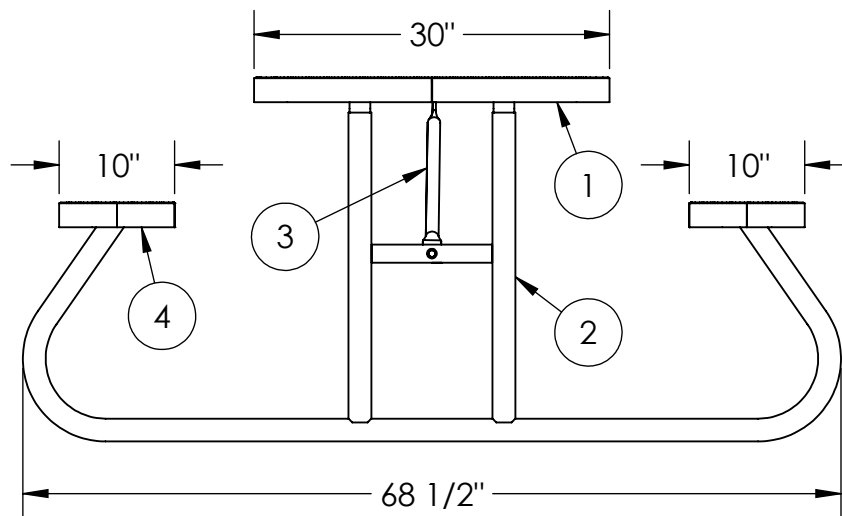

6' Champion Expanded Metal Free Standing Picnic Table

924-301

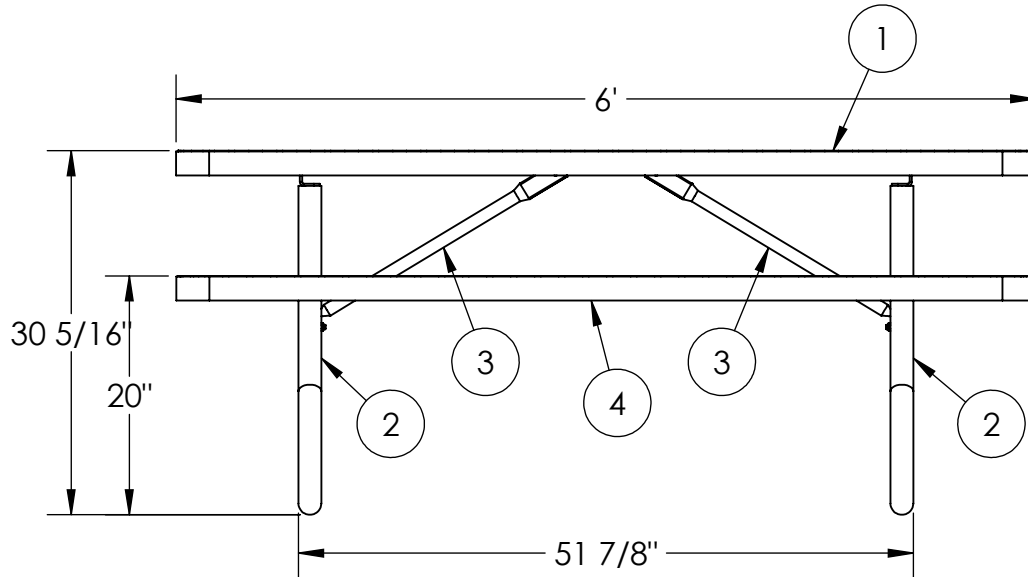

ITEM NO.	PART NUMBER	DESCRIPTION	QTY.
1	642-013	6' Champion Table Top	1
2	634-010	Free Standing Table Stand For Seats	2
3	634-013A	TABLE BRACE	2
4	622-013	Champion Seat/Back 6'	1
5	516-058	3/8"x1-1/2" SS Hex Bolt	14
6	516-023	3/8" SS Flat Washer	28
7	516-028	3/8" SS Nylock Nut	14



PREMIER POLYSTEEL

The Best Commercial Outdoor Furniture Available. Period.



SIZE
A

REV. X.01 SHEET 1 OF 2

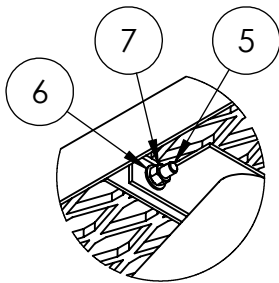
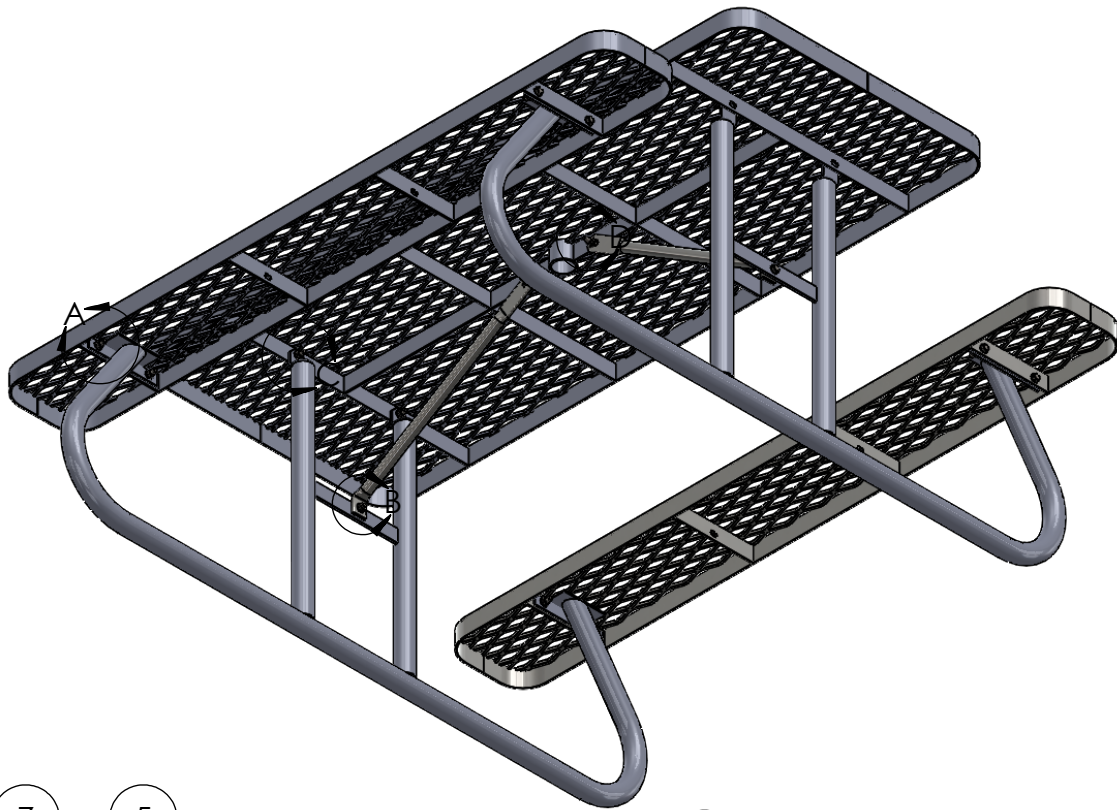

DETAIL A
SCALE 1 : 6

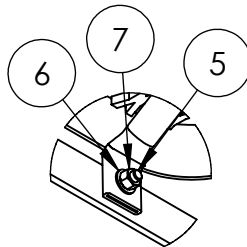

DETAIL B
SCALE 1 : 6

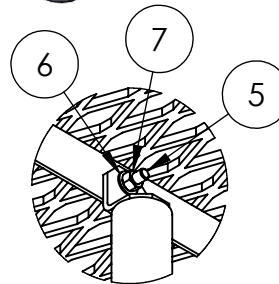

DETAIL C
SCALE 1 : 6

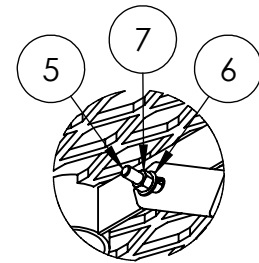

DETAIL D
SCALE 1 : 6

1. Drill out holes.
2. Attach both stands to the inside of table support bar. (See diagram above)
3. Attach the seats to the stands.
4. Attach the straight end of each brace to the table. (See diagram above)
5. Attach bent end of both braces to the cross bar of each stand. (See diagram above)

Tools List

- 7/16" Drill bit
- 9/16" Socket
- 9/16" Wrench
- 7/32" Allen Wrench
- Drill

Periodic check of bolts tightness recommended

In accordance to California law: **WARNING** - This product contains a chemical known to the State of California to cause cancer and birth defects or other reproductive harm.



PREMIER POLYSTEEL

The Best Commercial Outdoor Furniture Available. Period.

