

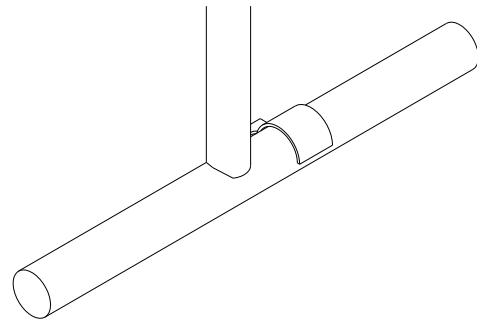

KIT-SM-L (S)

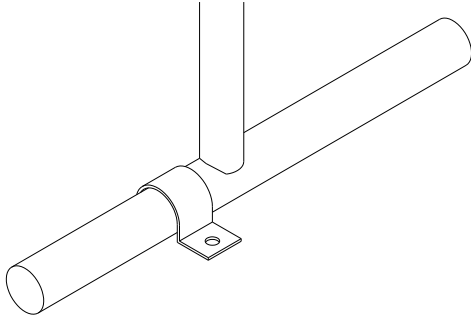

Part No.	Description	Qty.
CLAMP-L (S)	Large (Small) Clamp	2
516-047	3/8"x3-3/4" SS Concrete Anchor W/washer & nut	2

- 1 Position Bench in desired location and mark location of anchor bolts.
- 2 Drill hole in concrete using a 3/8" masonry bit. The hole should be at least 1-5/8" deep. (see illus. 1)
- 3 Clean the debris from the hole and check the depth.
- 4 Assemble the nut and washer. Drive the anchor through the hole in the clamp. (see illus. 2)
- 5 Tighten the nut 3 to 5 turns to expand the anchor. (see illus. 3)

In Accordance to California law: WARNING This product contains a chemical know to the State of California to cause cancer and birth defects or other reproductive harm.

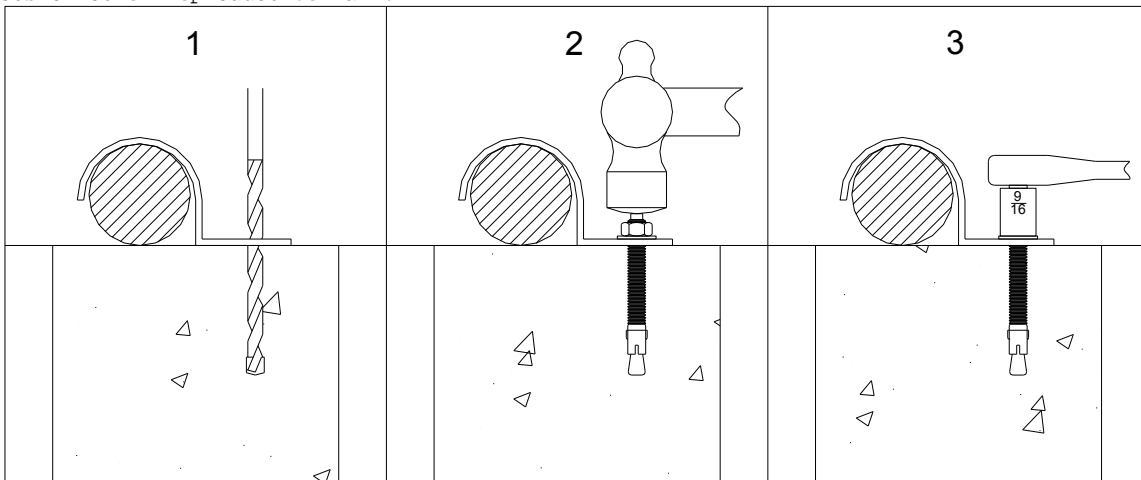

PREMIER POLYSTEEL

The Best Commercial Outdoor Furniture Available. Period.

